

# CYLINDER CY4

## SURFACE MOUNT

Highlight art, objects, places, spaces, seating areas, and architectural details with a classic profile that offers easy-to-adjust, in-field versatility.

PROJECT NAME:	TYPE:
---------------	-------

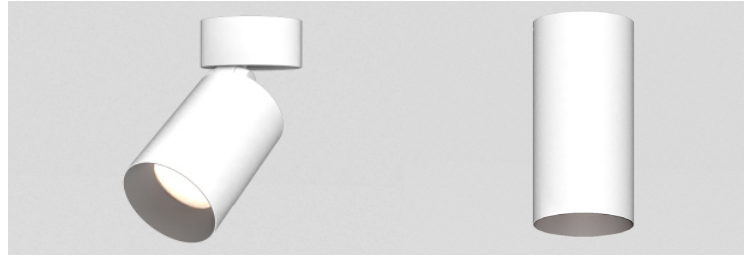

### ORDERING INFORMATION



JA8-2019 COMPLIANCE INDICATED BY SHADING

CYLINDER	FIXTURE	RATING	CYLINDER FINISH	BAFFLE FINISH	LUMEN PACKAGE	OCT	OPTIC	DRIVER	EFFECTS DEVICE	MOUNTING
<b>CY4</b>										
CY4 4.90"	<b>AD</b> Standard 90° <b>FB</b> Fixed Body <b>WW</b> Wallwash	1 Dry/Damp (IP30) 2 Wet (IP55)	<b>WH</b> White <b>AG</b> Satin Silver <b>AB</b> Architectural Bronze <b>BK</b> Black <b>CF</b> Custom Finish* <small>*(Consult Factory)</small>	<b>WH</b> White <b>AG</b> Satin Silver <b>AU</b> Cashmere Gold <b>AB</b> Architectural Bronze <b>BK</b> Black <b>CF</b> Custom Finish* <small>*(Consult Factory)</small>	<b>STATIC WHITE</b> <b>80C34B</b> 80+ CRI, AD/FB Dvld. Lumens - 2378 WW Dvld. Lumens - 2111 <b>80C45B</b> 80+ CRI, AD/FB Dvld. Lumens - 3513 WW Dvld. Lumens - 3118 <b>80C55B</b> 80+ CRI, AD/FB Dvld. Lumens - 4303 WW Dvld. Lumens - 3811 <b>90C29B</b> 90+ CRI, AD/FB Dvld. Lumens - 2251 WW Dvld. Lumens - 1998 <b>90C39B</b> 90+ CRI, AD/FB Dvld. Lumens - 3009 WW Dvld. Lumens - 2671 <b>90C47B</b> 90+ CRI, AD/FB Dvld. Lumens - 3678 WW Dvld. Lumens - 3265	27 2700K 30 3000K 35 3500K 40 4000K	15 15° 25 25° 40 40° 60 60° WW Wallwash Optic* <small>*(Required for Wallwash fixtures)</small>	<b>INTEGRAL</b> <b>1PH</b> 120V 1% ELV/TRIAC <b>1SG</b> 120 or 277V 1% 0-10V Analog, LOG <b>1SN</b> 120 or 277V 1% 0-10V Analog, LIN <b>REMOTE (120V)</b> <b>1L2</b> Lutron, Hi-Lume 1% 2-Wire* <small>*(Not available for 80C55B or 90C47B)</small> <b>REMOTE (120-277V)</b> <b>1LH</b> Lutron, Hi-Lume 1% Ecosystem* <small>*(Not available for 80C55B or 90C47B)</small> <b>1EG</b> eldoLED, SOLOdrive 0.1% 0-10V, LOG <b>1EN</b> eldoLED, SOLOdrive 0.1% 0-10V, LIN <b>1ED</b> eldoLED, SOLOdrive 0.1% DALI, LOG	<b>STANDARD EFFECTS DEVICE</b> <b>4</b> Soft Focus Lens <b>W</b> Wallwash Lens* <small>*(Required for Wallwash fixtures)</small> <b>OPTIONAL EFFECTS DEVICE</b> <b>0</b> No Lens* <small>*(Not available for Wet locations)</small> <b>2</b> Honeycomb Louver* <small>*(Not available for Wet locations)</small> <b>3</b> Clear Glass Lens <b>5</b> Frosted Glass Lens <b>6</b> Frosted Soft Focus Lens <b>7</b> Frosted Linear Spread Lens	<b>JBOX</b> Standard, J-Box Surface Mounting Plate <b>CMJB</b> 1/2" and 3/4" Conduit Ceiling Mount Junction Box* <small>*(Not available for Wet locations)</small>
			<b>TUNABLE WHITE</b> <b>90T20B</b> 90+ CRI, AD/FB Dvld. Lumens - 1874 WW Dvld. Lumens - 1306 <b>90T30B</b> 90+ CRI, AD/FB Dvld. Lumens - 2811 WW Dvld. Lumens - 2113	TW 5000K - 2700K	15 15° 25 25° 40 40° 60 60° WW Wallwash Optic* <small>*(Required for Wallwash fixtures)</small>	<b>TUNABLE WHITE REMOTE (120-277V)</b> <b>1DD</b> eldoLED, DUALdrive 0.1% DALI, LOG <b>1DG</b> eldoLED, DUALdrive 0.1% 0-10V, LOG <b>1DN</b> eldoLED, DUALdrive 0.1% 0-10V, LIN	*All delivered lumen outputs and T24 compliance reflect 3000K paired with 40° / WW Optic and standard effects device. Reference page 2 for additional T24 compliant configurations.	*All effects devices are T24 compliant for static white.		



### PART NUMBER NOTES

- CY4-AD ships as e.g., CY4AD1WHBK90C29B341SG\*4
- CY4-FB ships as e.g., CY4FB1WHBK80C34B441SG\*4
- CY4-WW ships as e.g., CY4WW1WHBK90C29B35SG\*W
- Remote driver ships as e.g., PSCY4-RMT-90C-29B-LH\*
- CMJB ships as CY4-CMJB-(finish)



**Declare.**

# CYLINDER CY4 SURFACE MOUNT

## ACCESSORIES

### ALTERNATE EFFECTS DEVICES

- HCL-CY4-01** Honeycomb Louver \*  
\*(Not available for Wet location)
- CGL-CY4-01** Clear Glass Lens
- SFL-CY4-01** Soft Focus Lens
- FGL-CY4-01** Frosted Glass Lens
- FSFL-CY4-01** Frosted Soft Focus Lens
- FLSL-CY4-01** Frosted Linear Spread Lens

### REPLACEMENT OPTIC ASSEMBLIES

- RO-90-15** 15° optic
- RO-90-25** 25° optic
- RO-90-40** 40° optic
- RO-90-60** 60° optic
- RO-90-WW** Wallwash optic

### EMERGENCY LIGHTING - REMOTE MOUNT ONLY

- EMB-S-100-120-LEDX** 100 watt max capacity, 120 VAC 60Hz, Dimmable
- EMB-S-100-277-LEDX** 100 watt max capacity, 277 VAC 60Hz, Dimmable
- EMB-S-250-120/277-LEDX** 250 watt max capacity, 120 or 277 VAC 60Hz, Dimmable

During disruption of main power, emergency battery inverter provides temporary 120V or 277V to fixture.

## PERFORMANCE - 3000K - STANDARD EFFECTS DEVICE

LUMEN PACKAGE	WATTAGE	15° OPTIC		25° OPTIC		40° OPTIC		60° OPTIC		WALLWASH OPTIC	
		DELIVERED	LPW	DELIVERED	LPW	DELIVERED	LPW	DELIVERED	LPW	DELIVERED	LPW
80C34B	28	2301	82	2335	83	2378	85	2185	78	2111	75
80C45B	39	3399	87	3449	88	3513	90	3228	83	3118	80
80C55B	50	4164	83	4225	84	4303	86	3955	79	3811	76
90C29B	28	2178	78	2210	79	2251	80	2068	74	1998	71
90C39B	39	2912	75	2954	76	3009	77	2765	71	2671	68
90C47B	50	3559	71	3611	72	3678	74	3380	68	3265	65
90T20B	31	1757	57	1805	58	1874	60	1720	55	1306	42
90T30B	49	2636	54	2708	55	2811	57	2580	53	2113	43



JA8-2019 INDICATED BY SHADING

STATIC WHITE OUTPUT MULTIPLIER	
CCT	CCT SCALE
2700K	0.957
3000K	1.000
3500K	1.019
4000K	1.030

LIGHT LOSS FACTOR MULTIPLIER	
Effect	Multiplier
No Lens	1.05
CGL	1.05
SFL	1.00
FGL	0.90
FSFL	0.87
FLSL	0.83
HCL	0.65

# CYLINDER CY4 SURFACE MOUNT

## FIXTURE

- A LUMINAIRE**  
Body with integrated heat sink and LED. Power supply may be integral or remote mount.
- B ADJUSTABLE CANOPY**  
Die-cast canopy accommodates flat and sloped ceiling conditions. Conceals hidden twist-on mounting hardware. Features 90° tilt and 2.25" tall canopy.
- C ADJUSTABLE AND FIXED BODY OPTIC**  
Field-changeable optics available in 15°, 25°, 40° and 60° beams.  
**WALLWASH OPTIC**  
Precision tuned kick reflector and optic provide uniform wallwashing effect.
- D ADJUSTABLE AND FIXED BODY LENS RETAINER**  
Threaded lens retainer attaches to baffle and accommodates up to two effects devices.
- E ADJUSTABLE AND FIXED BODY EFFECTS DEVICE**  
Soft focus lens standard. Effects device is field-changeable in Dry/Damp and Wet locations.  
**WALLWASH EFFECTS DEVICE**  
Wallwash lens is fixed to baffle and not field changeable.
- F BAFFLE**  
Die-cast baffle minimizes aperture glare and conceals view into fixture.

## DIMENSIONS / DRAWINGS

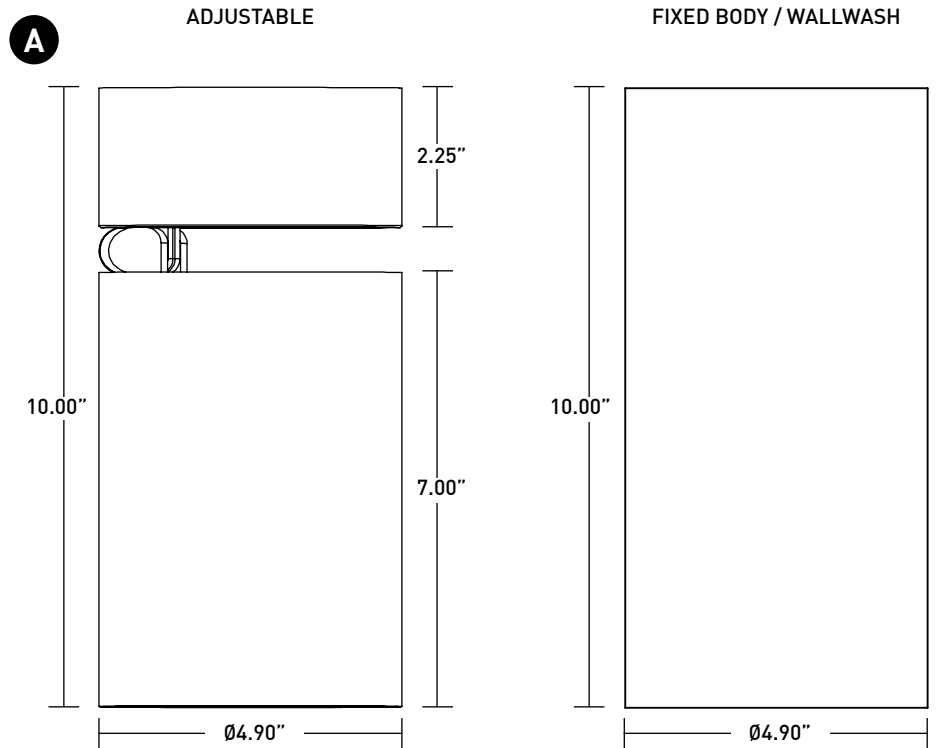

Fixture Weight - 6.0 lbs

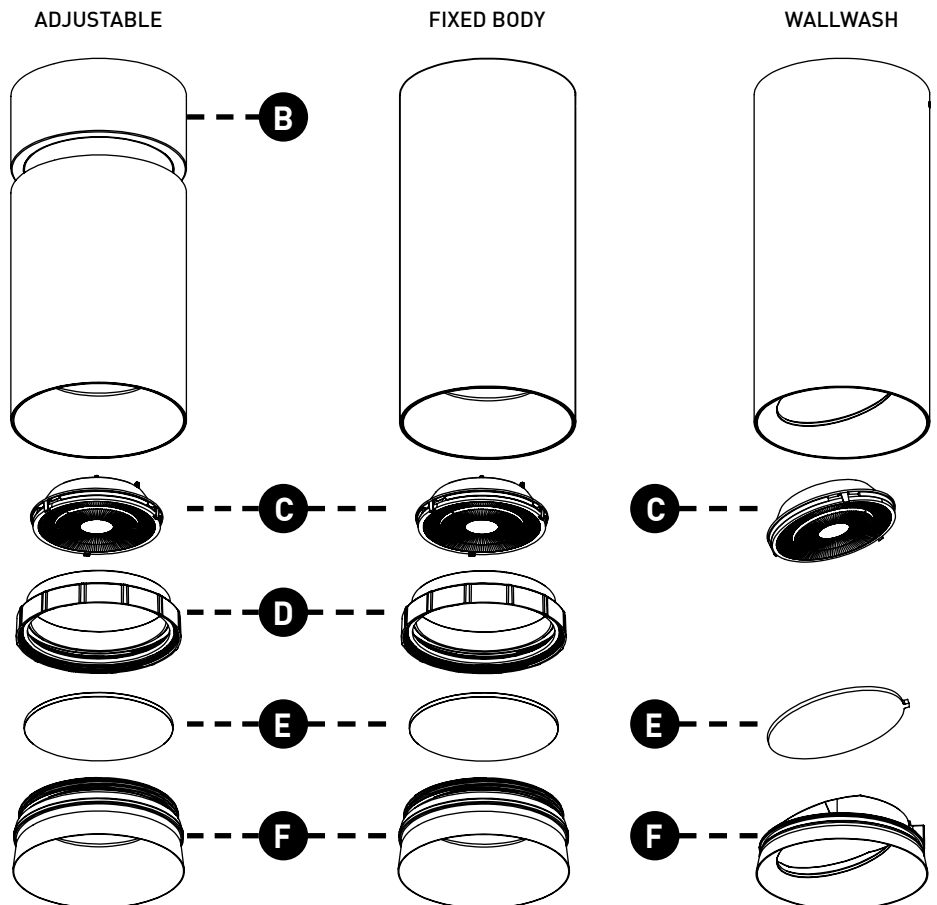

# CYLINDER CY4 SURFACE MOUNT

## MOUNTING

- G MOUNTING ADAPTOR**  
Mounting adaptor (concealed) for standard 3/0 and 4/0 j-boxes. Surface mounted, does not require installation prior to rough-in. Fixture mounts flush with minimalist transition to ceiling.
- H CMJB**  
Ceiling mount junction box perfectly matches the cylinder profile for a continuous, integrated look where exposed ceiling mount junction box and conduit applications apply. For use with 1/2" and 3/4" EMT conduit only. Features three conduit entrances at 12, 3, and 6 o'clock plus one conduit knockout on top. Painted finishes only. Blank off plugs included.

## REMOTE POWER SUPPLY

- I PS-RMT**  
Do not install in environments where ambient temperatures exceed 35°C (95°F). Remote power supply provides additional driver options. Mounting device still required. Consult install guide for maximum allowable secondary run lengths between PS-RMT and fixture.

## DIMENSIONS / DRAWINGS

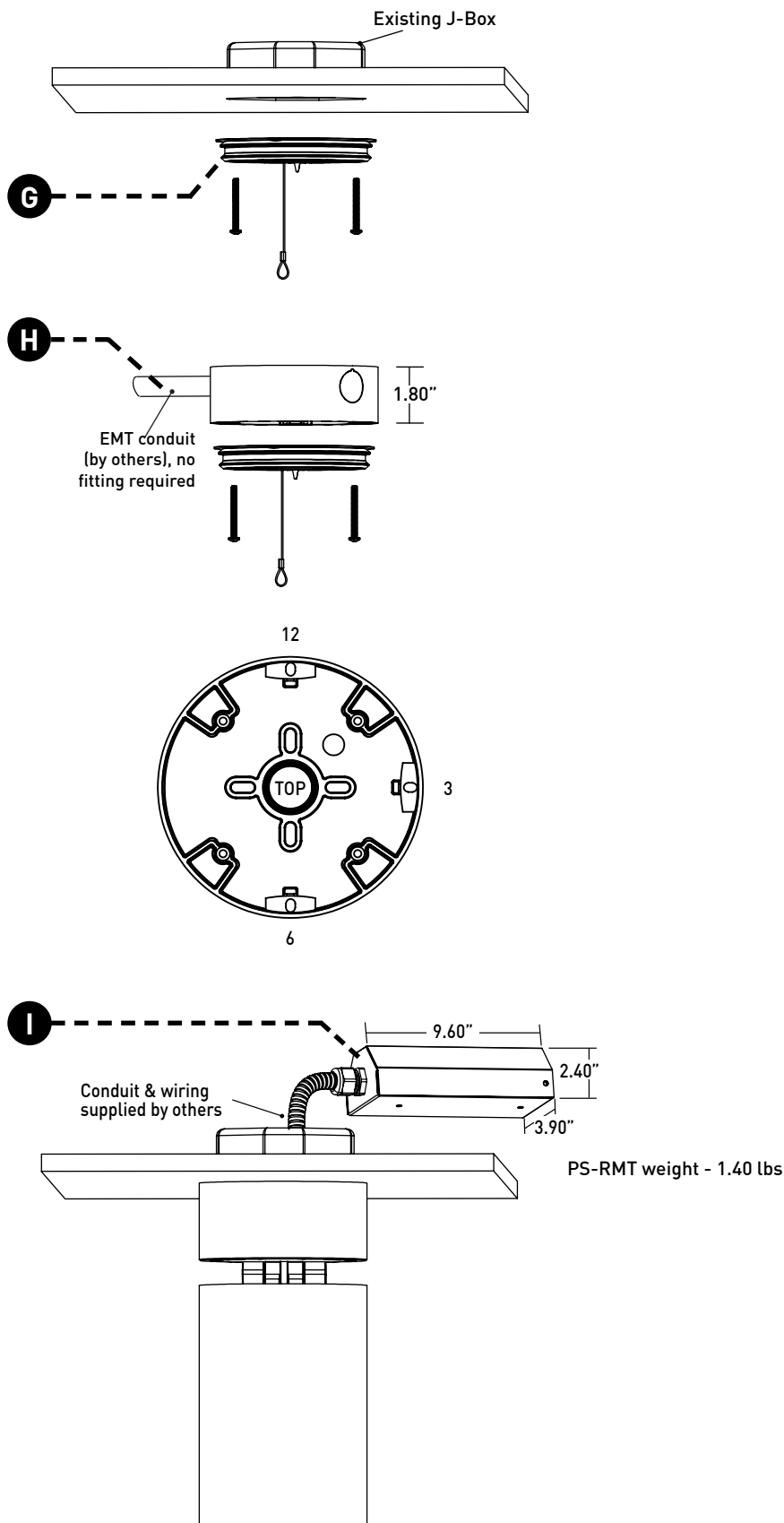

# CYLINDER CY4 SURFACE MOUNT

## TECHNICAL

### CONSTRUCTION

**Cylinder:** Machined aluminum body; extruded aluminum internal heat-sink; painted finishes are granulated powder coat.

**CMJB:** Die-cast aluminum body; painted finishes are granulated powder coat.

**Remote Power Supply:** 22 Gauge galvanized steel.

### LED

Proprietary Citizen 2 step MacAdam ellipse LED module available in 80+ and 90+ CRI configurations in color temperatures of 2700K, 3000K, 3500K and 4000K. Average rated lamp life of 50,000 hours. Driver assemblies are field-replaceable.

### TUNABLE WHITE LED

Proprietary 5-step MacAdam ellipse tunable white LED module available in 90+ CRI configuration. Features tuning range of 2700K to 5000K. Average rated lamp life: 50,000 hours. Driver assembly is field-replaceable.

### POWER SUPPLY PERFORMANCE AND DIMMING INFORMATION

Power Supply	1PH	1SG	1SN	1L2	1LH	1EG	1EN	1ED	1DD	1DG	1DN
Minimum °C	-10 °C	-10 °C	-10 °C	0 °C	0 °C	-20 °C	-20 °C	-20 °C	-20 °C	-20 °C	-20 °C
Maximum °C	40 °C	40 °C	40 °C	40 °C	40 °C	40 °C	40 °C	40 °C	40 °C	40 °C	40 °C
Dimming %	1.0%	1.0%	1.0%	1.0%	1.0%	0.1%	0.1%	0.1%	0.1%	0.1%	0.1%

Note: 1L2, 1LH, 1EG and 1EN drivers consult chart on page 6 to confirm appropriate dimming curve for compatibility with selected control.

### MAXIMUM ALLOWABLE REMOTE DRIVER WIRING DISTANCES

DRIVER	WIRE AWG				
	12	14	16	18	20
PH,SG,SN	285'	180'	113'	71'	45'
L2, LH	60'	40'	25'	15'	-
EG, EN, ED, DG, DN, DD	-	-	118'	72'	46'

### MOUNTING

Cylinder is supplied with a mounting adaptor, which integrates with standard 3/0 or 4/0 junction boxes. Ceiling-mount junction box available for 1/2" (13mm) and 3/4" (19mm) conduit and features concealed internal clamps for clean fitting-free conduit exit and entry.

### WALLWASH SPACING

Recommended fixture spacing is 48" on center with 48" setback from wall plane.

### LISTING

cTUVus listed to UL1598 standard for Dry / Damp and Wet locations. IP30 (Dry/Damp) rated at IEC60598 and IP55 (Wet) rated at IEC60529. Title 24 JA8-2019 Listed.

### BUY AMERICAN ACT

All CY4 configurations are Buy American Act compliant.

### DECLARE

LBC Red List Approved.

### WEIGHT

Adjustable - 5.4 lbs max  
Fixed / Wallwash - 6 lbs max  
Remote Driver - 1.4 lbs

### LIMITED WARRANTY

Manufacturer's 1-year warranty guarantees product(s) listed to be free from defects in material and workmanship under normal use and service. 5-year warranty on LED and power supply to operate with 70% of the original flux and remain within a range of 3 duv. 10-year Lutron Advantage limited warranty available on Lutron equipped systems. Warranty period begins from the date of shipment by Seller and conditional upon the use of manufacturer-supplied power supply. Consult [website](#) for full warranty terms and conditions.

### CHANGE LOG

- 01/06/2022: ADDED TITLE 24 JA8-2019 LISTING.
- 04/26/2023: ADDED DECLARE LBC RED LIST APPROVED.

# CYLINDER CY4 SURFACE MOUNT

## DIMMING COMPATIBILITY

### LUTRON DRIVER COMPATIBILITY

Power supply <b>1L2</b> Lutron Product Family	Part No.
Maestro WirelessR 600 W dimmer	MRF2-6ND-120-
Maestro WirelessR 1000 W dimmer	MRF2-10ND-120-
Caséta® Wireless Pro 1000 W dimmer	PD-10NXD-
GRAFIK T™ CL® dimmer	GT-250M- GTJ-250M-
HomeWorks® QS adaptive dimmer	HQRD-6NA-
HomeWorks® QS 600 W dimmer	HQRD-6ND-
HomeWorks® QS 1000 W dimmer	HQRD-10ND-
RadioRA® 2 adaptive dimmer	RRD-6NA-
RadioRA® 2 1000 W dimmer	RRD-10ND
myRoom™ DIN power module	MQSE-4A1-D
HomeWorks® QS DIN power module	LQSE-4A1-D
HomeWorks® QS wallbox power module	HQRJ-WPM-6D-120
HomeWorks® wallbox power module	HWI-WPM-6D-120
GRAFIK Eye® QS control unit	QSGR-, QSGRJ-
GRAFIK Eye® 3000 control unit	GRX-3100- GRX-3500-
RPM-4U module (LCP, HomeWorks® QS, GRAFIK Systems™, Quantum®)	HW-RPM-4U-120 LP-RPM-4U-120
RPM-4A module (LCP, HomeWorks® QS, GRAFIK Systems™, Quantum®)	HW-RPM-4A-120, LP-RPM-4A-120
GP dimming panels	Various
Ariadni CL 250W dimmer	AYCL-253P-
Diva CL 250W dimmer	DVCL-253P- DCSCCL-253P-
Nova T CL 250W dimmer	NTCL-250-
Power supply <b>1LH</b> Lutron Product Family	Part No.
PowPak Dimming Modules	RMJ-ECO32-DV-B
PowPak Dimming Modules	FCJ/FCJS-ECO
Energi Savr Nodes	QSN-1ECO-S
GRAFIK Eye QS control unit	QSN-2ECO-S
Homeworks QS control unit	QSGRJ- _E (wireless) QSGR- _E
Quantum Hub	QP2-__ _2C
Quantum Hub	QP2-__ _4C
Quantum Hub	QP2-__ _6C
Quantum Hub	QP2-__ _8C
Homeworks QS power module	LQSE-2ECO-D
myRoom Plus power module	

### eldoLED DRIVER COMPATIBILITY

Power supply <b>EA2</b> Manufacturer	Family/Model #
Busch-Jaeger	2112U-101
Jung	240-10
Leviton Lighting Controls	IP710-DLX
Lightolier Controls	ZP600FAM120
Merten	5729
Pass & Seymour	CD4FB-W
The Watt Stopper	DCLV1
Synergy	ISD BC
Crestron®	GLX-DIMFLV8
Crestron®	GLXP-DIMFLV8
Crestron®	GLPAC-DIMFLV4-*
Crestron®	GLPAC-DIMFLV8-*
Crestron®	GLPP-DIMFLVEX-PM
Crestron®	GLPP-1DIMFLV2EX-PM
Crestron®	GLPP-1DIMFLV3EX-PM
Crestron®	DIN-A08
Crestron®	DIN-4DIMFLV4
Crestron®	CLS-EXP-DIMFLV
Crestron®	CLCI-1DIMFLV2EX
Power supply <b>LA2</b> Manufacturer	Family/Model #
Lutron Electronics	Nova T® - NTFTV
Lutron Electronics	Diva® - DVTV
Lutron Electronics	Nova® - NFTV
Lutron Electronics	GrafixEye® GRX-TVI w GRX3503
Lutron Electronics	Energy Savr Node™ - QSN-4T16-S
Lutron Electronics	TVM2 Module
Sensor Switch	nIO EZ
ABB	SD/S 2.16.1

