

0 SERIES INT FIXED

PROJECT NAME:

TYPE:

- Max output of 990lm at 80+ CRI
- Available with trimless and zero sightline baffles, featuring 0.5" (13mm) aperture

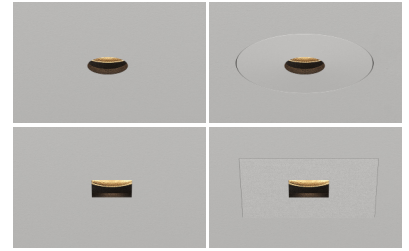

ORDERING INFORMATION - FIXTURE

TRIM	RATING	TYPE	BAFFLE & MOUNTING	EXTERIOR FINISH	INTERIOR FINISH	CRI	WATTAGE	CCT	OPTIC	MEDIA	INSTALL TYPE	CEILING THICKNESS	DRIVER
		F			BK							1	
ORM 1/2" (13mm) Round Micro OSM 1/2" (13mm) Square Micro	1 IP20 Dry/Damp 2 IP64 Wet	Fixed	T Trimless G Zero Sightline Gypsum	TRIMLESS TG Trimless Gypsum* *Required for trimless gypsum ZERO SIGHTLINE POWDERCOAT WH White AG Satin Silver AU Cashmere Gold AB Architectural Bronze BB Burnt Bronze BK Black SB Specular Black PR Primer CF Custom Finish* *(Consult Factory) ALUMINA 01 Brushed Obsidian 02 Matte Obsidian 03 Brushed Dark Patinated Bronze 04 Matte Dark Patinated Bronze 05 Brushed Aged Aluminum 06 Matte Aged Aluminum 07 Brushed Cast Brass 08 Matte Cast Brass 09 Brushed Light Patinated Bronze 10 Matte Light Patinated Bronze	BK Black FINISH IMAGES ON PAGE 2	STATIC WHITE 80S 80+ CRI 90S 90+ CRI 95S 95+ CRI	TRIMLESS 06C 6W, 416 lm 11C 11W, 634 lm 15C 15W, 842 lm ZERO SIGHTLINE 06C 6W, 423 lm 11C 11W, 644 lm 15C 15W, 856 lm DELIVERED LUMEN OUTPUTS REFLECT 90CRI, 3000K, 40° OPTIC, AND NO LENS.	24 2400K* *90 CRI only 27 2700K 30 3000K 35 3500K 40 4000K	20 20° 30 30° 40 40°	NL No Lens 01 Clear Film* *(Required for wet location)	EXPORT (REMOTE DRIVER) EX Export Remote EN Export NOM EB Export BIS HOUSING (TETHERED DRIVER) HX Housing Export HN Export NOM HB Housing BIS	1 13mm - 38mm	IG1 eldoLED, SOLOdrive 0.1% 0-10V, LOG, 120V-277V IN1 eldoLED, SOLOdrive 0.1% 0-10V, LIN, 120V-277V ID1 eldoLED, SOLOdrive 0.1% DALI-2, LOG, 120V-277V

PART NUMBER NOTES

- Fixture ships as e.g., 0RM1FTTGAUBK90S15C3540NLEX1IG1
- Housing, driver, trim, and applique ship as one unit

0 SERIES INT FIXED

ACCESSORIES

REPLACEMENT OPTICS

Interchangeable optics accessible through fixture aperture.

- ☐ **RO-17-20** 20° optic
- ☐ **RO-17-30** 30° optic
- ☐ **RO-17-40** 40° optic

REPLACEMENT BAFFLE ASSEMBLY (INCLUDES MEDIA)

ASSEMBLY	SHAPE	RATING	TYPE	BAFFLE	EXTERIOR FINISH	INTERIOR FINISH	MEDIA
RBA			F			BK	
REPLACEMENT BAFFLE ASSEMBLY	ORM Round OSM Round	1 IP20 Dry/Damp 2 IP64 Wet* * (Suction cup provided for aim and focus)	F Fixed	T Trimless G Zero Sightline	TG Trimless Gypsum WH White AG Satin Silver AU Cashmere Gold AB Arch. Bronze BB Burnt Bronze BK Black PR Primer CF Custom Finish * *(Consult Factory) *See page 1 for Alumina finish options	BK Black	NL No Lens 01 Clear-Glass Lens

REPLACEMENT INSTALLATION TOOLS

One included with every six fixtures designated Wet location.

- ☐ **01S-TOOL-BAFFLE-REMOVAL** Allows for removal of baffle with Wet location
- ☐ **01S-TOOL-ENGINE-INST-REMOVAL** Allows for installation of LED module
- ☐ **01S-TOOL-ENGINE-BAFFLE-COMBO** Includes both baffle removal tool and LED module installation tool.

EMERGENCY LIGHTING - REMOTE MOUNT ONLY

During disruption of main power, emergency battery inverter provides temporary 120V or 277V to fixture.

- ☐ **EMB-S-25-120/277-LEDX** 25 watt max capacity, 120 or 277 VAC 60Hz, Non-Dimmable
- ☐ **EMB-S-100-120-LEDX** 100 watt max capacity, 120 VAC 60Hz, 0-10V Dimmable
- ☐ **EMB-S-100-277-LEDX** 100 watt max capacity, 277 VAC 60Hz, 0-10V Dimmable
- ☐ **EMB-S-250-120/277-LEDX** 250 watt max capacity, 120 or 277 VAC 60Hz, 0-10V Dimmable

***SHUNT REQUIRED FOR USE WITH ATHENA AND CASAMBI CONTROLS, CONSULT FACTORY FOR DETAILS.**

POWDERCOAT FINISHES

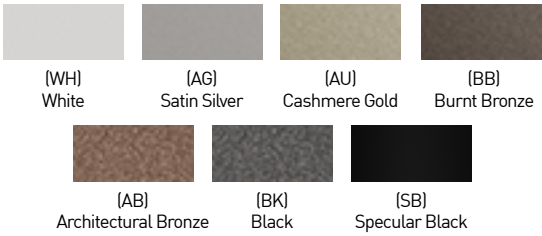

ALUMINA FINISHES BY LUCIFER LIGHTING™



0 SERIES INT FIXED

PERFORMANCE - TRIMLESS - 3000K - NO LENS

LUMEN PACKAGE	WATTS	20° OPTIC		30° OPTIC		40° OPTIC	
		DLVD	LPW	DLVD	LPW	DLVD	LPW
80S06C	6	215	36	389	65	481	80
80S11C	11	327	30	592	54	733	67
80S15C	15	435	29	787	52	974	65
90S06C	6	186	31	336	56	416	69
90S11C	11	283	26	512	47	634	58
90S15C	15	376	25	680	45	845	56
95S06C	6	134	22	242	40	299	50
95S11C	11	203	18	368	33	455	41
95S15C	15	270	18	489	33	605	40

OUTPUT MULTIPLIER	
CCT	CCT SCALE
2400K	0.89
2700K	0.98
3000K	1.00
3500K	1.09
4000K	1.14

MEDIA LIGHT LOSS MULTIPLIER	
MEDIA	LIGHT LOSS FACTOR
NO LENS	1.00
LENS	0.93

PERFORMANCE - ZERO SIGHTLINE - 3000K - NO LENS

LUMEN PACKAGE	WATTS	20° OPTIC		30° OPTIC		40° OPTIC	
		DLVD	LPW	DLVD	LPW	DLVD	LPW
80S06C	6	234	39	407	68	490	82
80S11C	11	357	32	620	56	745	68
80S15C	15	474	32	824	55	990	66
90S06C	6	203	34	352	59	423	71
90S11C	11	309	28	536	49	644	59
90S15C	15	410	27	712	47	856	57
95S06C	6	146	24	253	42	304	51
95S11C	11	222	20	385	35	463	42
95S15C	15	295	20	512	34	615	41

FINISH MULTIPLIER	
CCT	CCT SCALE
WHITE	1.00
BLACK	0.98
SPECULAR BLACK	0.98

O SERIES INT FIXED

DOWNLIGHT / HOUSING

A HIGH/LOW WATTAGE REMODEL HOUSING

- For remote installation types.
- IC-rated heatsink, does not have any setback requirements from combustible and non-combustible materials.
- High wattage housing features 54mm tall heat sink and is available for 15W packages.
- Low wattage housing features 35mm tall heat sink and is available for 6W and 11W packages only.

B LIGHT ENGINE

Robust light engine with optimized optic pairing integrates Reflection, Refraction, and TIR offering 20°, 30°, and 40° beams.

C REMODEL MOUNTING PLATE

Installs above ceiling, requiring 147mm cutout. Rectangular design (156mm x 178mm) allows for installation above ceiling after cutout. Mounting holes align with applique, ensuring secure fixture mounting via factory supplied screws.

D ZERO-SIGHTLINE / TRIMLESS DRYWALL PROFILE

Installs totally flush with the ceiling with no visible trim. Appliqué includes screws for mounting and has 1.5mm plaster stop. Not recommended for stucco applications. See page 5 for applique section view and visible baffle profiles after mud-in.

E ZERO-SIGHTLINE FACEPLATE / BAFFLE

CNC-Milled removable baffle provides 64° glare cutoff. Minimizes aperture glare and conceals view into housing; includes gasket. Exterior faceplate available in powdercoat finishes; interior finish is black powdercoat.

F TRIMLESS BAFFLE

CNC-Milled baffle provides 61° glare cutoff. Minimizes aperture glare and conceals view into housing; includes gasket. Baffle shape is square for both round and square apertures. Only 13mm inner aperture is visible after mud-in. **43mm square ceiling break required for LED/driver servicing.**

G FITTING WITH REMOTE POWER SUPPLY

- Requires 168mm cutout.
- Protected wiring and connecting hardware between fitting and power supply.
- Do not install in environments where ambient temperatures exceed 40°C (104°F).
- Fixtures accommodate ceiling thicknesses between 13mm and 38mm

DIMENSIONS / DRAWINGS

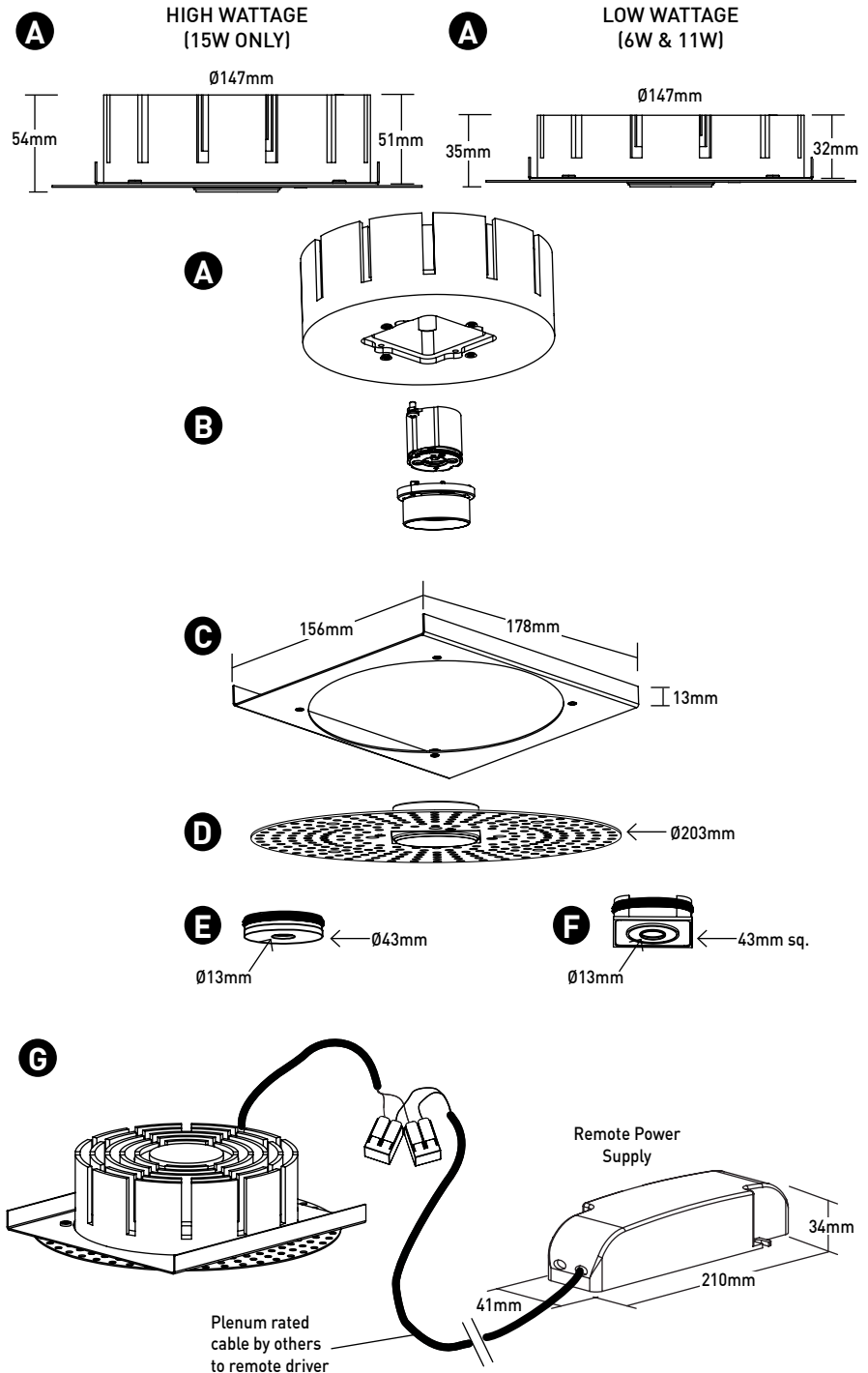

0 SERIES INT FIXED

DOWNLIGHT / HOUSING

H HOUSING-BASED FIXTURE WITH TETHERED DRIVER

- For "HX", "HB", and "HN" installation types.
- Power supply attached to LED and housing, allowing for roomside driver servicing.
- Factory supplied terminal block utilized for line voltage connections.
- Requires 121mm x 146mm rectangular cut-out.

I LIGHT ENGINE

Robust light engine with optimized optic pairing integrates Reflection, Refraction, and TIR offering 20°, 30°, and 40° beams.

J ZERO-SIGHTLINE / TRIMLESS DRYWALL PROFILE

Installs totally flush with the ceiling with no visible trim. Appliqué includes screws for mounting and has 1.5mm plaster stop. Not recommended for stucco applications.

K ZERO-SIGHTLINE FACEPLATE / BAFFLE

CNC-Milled removable baffle provides 64° glare cutoff. Minimizes aperture glare and conceals view into housing; includes gasket. Exterior faceplate available in powdercoat finishes; interior finish is black powdercoat.

L TRIMLESS BAFFLE

CNC-Milled baffle provides 61° glare cutoff. Minimizes aperture glare and conceals view into housing; includes gasket. Baffle shape is square for both round and square apertures. Only 13mm inner aperture is visible after mud-in. **43mm square ceiling break required for LED/driver servicing.**

DIMENSIONS / DRAWINGS

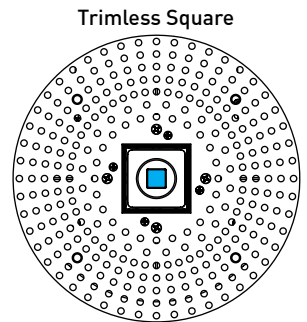
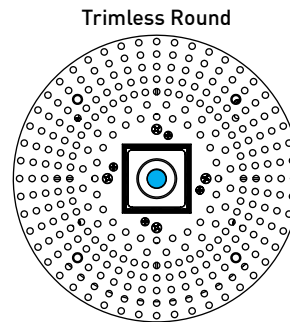
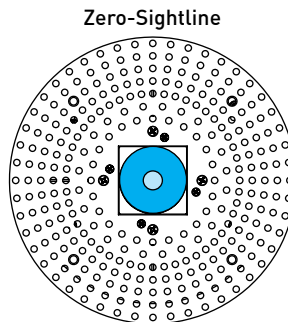
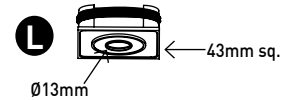
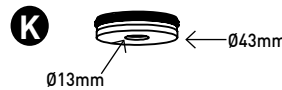
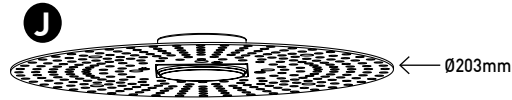
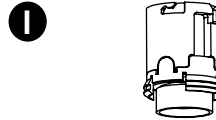
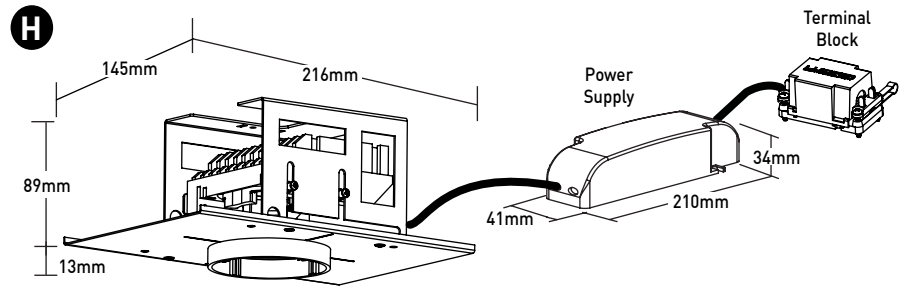

Visible after mud-in

SECTION VIEW

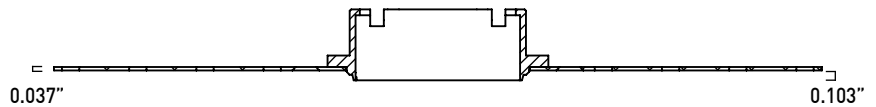

0 SERIES INT FIXED

TECHNICAL

CONSTRUCTION

Downlight: Painted finishes are granulated powder coat; Alumina finishes are anodized aluminum. Plated finishes are plated.

Housing: Forged aluminum heat-sink.

Appliqué: Aluminum base with 22 Gauge galvanized steel flange.

STATIC WHITE LED



2-step MacAdam ellipse LED module available in 80+, 90+, and 95+ CRI configurations in color temperatures of 2700K, 3000K, 3500K and 4000K.
3-step MacAdam ellipse LED module available in 90+ CRI configuration in color temperature of 2400K. Average rated lamp life of 50,000 hours. LED and driver assemblies are field-replaceable.

POWER SUPPLY PERFORMANCE AND DIMMING INFORMATION

	0-10V		DALI-2
Power Supply	IG1	IN1	ID1
Minimum °C	-20 °C	-20 °C	-20 °C
Maximum °C	40 °C	40 °C	40 °C
Dimming %	0.1%	0.1%	0.1%

Note: For IG1 and IN1 drivers consult chart on page 7 to confirm appropriate dimming curve for compatibility with selected control

MAXIMUM ALLOWABLE REMOTE DRIVER WIRING DISTANCES

DRIVER	WIRE AWG				
	12	14	16	18	20
IG1, IN1, ID1	-	-	36m	22m	14m

LISTING

CE Listed for IP20 Dry / Damp and IP64 Wet locations.

WEIGHT

32mm Remodel Housing - 1.36kg
51mm Remodel Housing - 1.81kg
Remote Driver - .64kg

LIMITED WARRANTY

Manufacturer's Limited Warranty guarantees product(s) listed to be free from defects in material and workmanship under normal use and service for 1-year. LED and power supplies are warranted to operate with 70% of original flux and remain within a range of 3 duv for a period of 5-years. 10-year Lutron Advantage limited warranty available on Lutron equipped systems. Warranty period begins from the date of shipment by Seller.

eldoLED DRIVER COMPATIBILITY

Power supply IG1 Manufacturer	Family/Model #
Busch-Jaeger	2112U-101
Jung	240-10
Leviton Lighting Controls	IP710-DLX
Lightolier Controls	ZP600FAM120
Merten	5729
Pass & Seymour	CD4FB-W
The Watt Stopper	DCLV1
Synergy	ISD BC
Crestron®	GLX-DIMFLV8
Crestron®	GLXP-DIMFLV8
Crestron®	GLPAC-DIMFLV4-*
Crestron®	GLPAC-DIMFLV8-*
Crestron®	GLPP-DIMFLVEX-PM
Crestron®	GLPP-1DIMFLV2EX-PM
Crestron®	GLPP-1DIMFLV3EX-PM
Crestron®	DIN-A08
Crestron®	DIN-4DIMFLV4
Crestron®	CLS-EXP-DIMFLV
Crestron®	CLCI-1DIMFLV2EX
Power supply IN1	Family/Model #
Lutron Electronics	Nova T® - NTFTV
Lutron Electronics	Diva® - DDTV
Lutron Electronics	Nova® - NFTV
Lutron Electronics	GrafixEye® GRX-TVI w GRX3503
Lutron Electronics	Energy Savr Node™ - QSN-4T16-S
Lutron Electronics	TVM2 Module
Sensor Switch	nI0 EZ
ABB	SD/S 2.16.1

ANALOG DRIVERS AND DIMMERS

