

MONOPOINT INTERNATIONAL CM1 SURFACE MOUNT

Elegant design means this monopoint does more. An inventive elbow built into the fixture body that allows a full 90 degree tilt and drop lengths of up to 1' extend adjustability.

ORDERING INFORMATION - MONOPOINT

| CYLINDER | LENGTH | FIXTURE | BODY FINISH | BAFFLE FINISH | STEM FINISH | CRI / WATTAGE PACKAGE | CCT | OPTIC (UGR) | DRIVER | MEDIA | MOUNTING |
|------------|---|---|--|--|--|--|--|--|---|--|---|
| CM1 | | | | | | | | | | | E |
| CM1 66mm | LENGTHS SL 1.4" Standard 06 6" 12 12" | ADJUSTABLE DRY / DAMP AD1 Adjustable 90° Tilt | POWDERCOAT WH White BK Black AB Architectural Bronze AG Satin Silver AU Cashmere Gold BB Burnt Bronze CF Custom Finish* *(Consult Factory) | POWDERCOAT WH White BK Black AB Architectural Bronze AG Satin Silver AU Cashmere Gold BB Burnt Bronze CF Custom Finish* *(Consult Factory) | POWDERCOAT WH White BK Black AB Architectural Bronze AG Satin Silver AU Cashmere Gold BB Burnt Bronze CF Custom Finish* *(Consult Factory) | STATIC WHITE 80S11A 80+ CRI, 11 Watts Lumens Delivered - 1095 90S11A 90+ CRI, 11 Watts Lumens Delivered - 941 97S11A 97+ CRI, 11 Watts Lumens Delivered - 826 | 24 2400K* *(90+ CRI only) 27 2700K 30 3000K 35 3500K 40 4000K | 10 10° (>19) 15 15° (<13) 20 20° (<10) 25 25° (<10) 40 40° (<10) 60 60° (<13) | IE Electronic ELV / TRIAC 220V-240V | STANDARD MEDIA 4 Soft Focus Lens* *(Required for 10° optic) | E EXMP Export Mounting Plate. Features 66mm diameter canopy |
| | | FIXED TILT WET (IP65) F02 Fixed 0° No Tilt* F12 Fixed 15° Tilt* F32 Fixed 30° Tilt* F42 Fixed 45° Tilt* | ALUMINA INTERIOR APPLICATIONS ONLY 01 Brushed Obsidian 02 Matte Obsidian 03 Brushed Dark Patinated Bronze 04 Matte Dark Patinated Bronze 05 Brushed Aged Aluminum 06 Matte Aged Aluminum 07 Brushed Cast Brass 08 Matte Cast Brass 09 Brushed Light Patinated Bronze 10 Matte Light Patinated Bronze ALUMINA NOT RECOMMENDED FOR EXTERIOR APPLICATIONS, FINISHES ARE NOT UV RATED | ALUMINA CONSULT FACTORY FOR ALUMINA FINISHES | ALUMINA CONSULT FACTORY FOR ALUMINA FINISHES | REMOTE STATIC WHITE 80S17A 80+ CRI, 17 Watts Lumens Delivered - 1655 90S17A 90+ CRI, 17 Watts Lumens Delivered - 1422 97S17A 97+ CRI, 17 Watts Lumens Delivered - 1249 | 24 2400K* *(90+ CRI only) 27 2700K 30 3000K 35 3500K 40 4000K | 10 10° (>19) 15 15° (<16) 20 20° (<10) 25 25° (<10) 40 40° (<10) 60 60° (<16) | IN eldoLED, SOLOdrive 0.1% 0-10V, LOG 120V-277V ID eldoLED, SOLOdrive 0.1% DALI-2, LOG 120V-277V | ALTERNATE MEDIA 2 Honeycomb Louver* *(Not available for IP65 Wet Location) 3 Clear Glass Lens 5 Frosted Glass Lens 6 Frosted Soft Focus Lens 7 Frosted Linear Spread Lens S Soft Focus Lens w/ Honeycomb Louver F Frosted Glass Lens w/ Honeycomb Louver N No Lens* *(Not available for IP65 Wet Location) | |
| | | | | | | WARM DIM 90L11A 90+ CRI, 11 Watts Incandescent Profile Lumens Delivered - 654 Halogen Profile Lumens Delivered - 658 | WL 2700K - 1800K WD 3000K - 1800K | 15 15° (<13) 20 20° (<10) 25 25° (<10) 40 40° (<10) 60 60° (<13) | DD eldoLED, DUALdrive 0.1% DALI-2, LOG 120V-277V | | |
| | CUSTOM LENGTHS XX Specify in 1" increments between 2"-11" [Ex. 4" = 04]* *(Increased lead time) | | | | | REMOTE WARM DIM 90L17A 90+ CRI, 17 Watts Incandescent Profile Lumens Delivered - 1017 Halogen Profile Lumens Delivered - 1017 | WL 2700K - 1800K WD 3000K - 1800K | 15 15° (<13) 20 20° (<10) 25 25° (<10) 40 40° (<10) 60 60° (<13) | | | |
| | | | | | | SEE PAGE 4 FOR WARM DIM PROFILE COMPARISON | | | | | |
| | | | | | | REMOTE TUNABLE WHITE 90T17A 90+ CRI, 17W Cool Profile: 5000K - 2700K Lumens Delivered - 888 Warm Profile: 4000K - 1800K Lumens Delivered - 896 | TH 5000K - 2700K TR 4000K - 1800K | 15 15° (<13) 20 20° (<10) 25 25° (<10) 40 40° (<10) 60 60° (<13) | | | |
| | STEMS ARE NOT FIELD CUTTABLE | | | | | ALL LUMENS DELIVERED REFLECT 3000K PAIRED WITH 25° OPTIC AND SOFT FOCUS LENS | | | | | |
| | | | | | | | | | | | |
| | | | | | | | | | | | |
| | | | | | | | | | | | |
| | | | | | | | | | | | |

PART NUMBER NOTES

- CM1 ships as e.g., CM124HS1WHBK90S11*3040IE*4E
- Remote driver ships as e.g., PS-RMT-90S-17A-2IG*

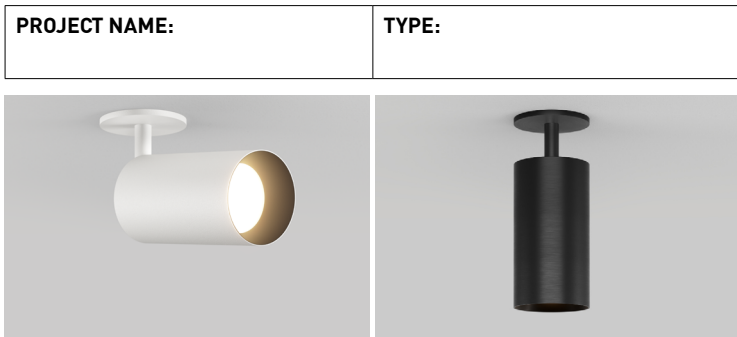

MONOPOINT INTERNATIONAL CM1 SURFACE MOUNT

FINISHES

POWDERCOAT FINISHES



(WH)
White



(BK)
Black



(AB)
Architectural Bronze



(AG)
Satin Silver



(AU)
Cashmere Gold



(BB)
Burnt Bronze

ALUMINA FINISHES BY LUCIFER LIGHTING™



(01)
Brushed Obsidian



(03)
Brushed Dark Patinated Bronze



(05)
Brushed Aged Aluminum



(07)
Brushed Cast Brass



(09)
Brushed Light Patinated Bronze



(02)
Matte Obsidian



(04)
Matte Dark Patinated Bronze



(06)
Matte Aged Aluminum



(08)
Matte Cast Brass



(10)
Matte Light Patinated Bronze

ACCESSORIES

REPLACEMENT MEDIA

- ☐ **HCL-CT1** Honeycomb Louver*
- ☐ **CGL-CT1** Clear Glass Lens
- ☐ **SFL-CT1** Soft Focus Lens
- ☐ **FGL-CT1** Frosted Glass Lens
- ☐ **FSFL-CT1** Frosted Soft Focus Lens
- ☐ **FLSL-CT1** Frosted Linear Spread Lens

REPLACEMENT OPTICS

Interchangeable optics accessible by removing baffle.

- Static White**

 - ☐ **RO-50-15-S** 15° optic
 - ☐ **RO-50-20-S** 20° optic
 - ☐ **RO-50-25-S** 25° optic
 - ☐ **RO-50-40-S** 40° optic
 - ☐ **RO-50-60-S** 60° optic
- Warm Dim**

 - ☐ **RO-50-15-W** 15° optic
 - ☐ **RO-50-20-W** 20° optic
 - ☐ **RO-50-25-W** 25° optic
 - ☐ **RO-50-40-W** 40° optic
 - ☐ **RO-50-60-W** 60° optic
- Tunable White**

 - ☐ **RO-50-15-S** 15° optic
 - ☐ **RO-50-20-S** 20° optic
 - ☐ **RO-50-25-S** 25° optic
 - ☐ **RO-50-40-S** 40° optic
 - ☐ **RO-50-60-S** 60° optic

REPLACEMENT BAFFLE ASSEMBLY (INCLUDES MEDIA)

| ASSEMBLY | SHAPE | RATING | FINISH | MEDIA |
|-----------------------------------|------------|--|--|---|
| RBA | CM1 | | | |
| REPLACEMENT BAFFLE ASSEMBLY | CM1 66mm | 1 IP20 Dry/Damp 2 IP65 Wet* <small>* (Requires provided suction cup to service)</small> | WH White BK Black AB Architectural Bronze AG Satin Silver AU Cashmere Gold BB Burnt Bronze PR Primer CF Custom Finish * <small>*(Consult Factory)</small> | LEAVE BLANK FOR SOFT FOCUS LENS (SFL) HCL Honeycomb Louver* <small>*(Not available for Wet Location)</small> CGL Clear Glass Lens FGL Frosted Glass Lens FSFL Frosted Soft Focus Lens FLSL Frosted Linear Spread Lens NL No Lens * <small>*(Not available for Wet Location)</small> |

MONOPOINT INTERNATIONAL CM1 SURFACE MOUNT

PERFORMANCE - 3000K

| LUMEN PACKAGE | WATTAGE | 10° OPTIC FIELD REDUCER | | 15° OPTIC SOFT FOCUS LENS | | 20° OPTIC SOFT FOCUS LENS | | 25° OPTIC SOFT FOCUS LENS | | 40° OPTIC SOFT FOCUS LENS | | 60° OPTIC SOFT FOCUS LENS | |
|-------------------------|---------|----------------------------|-----|------------------------------|-----|------------------------------|-----|------------------------------|-----|------------------------------|-----|------------------------------|-----|
| | | DELIVERED | LPW | DELIVERED | LPW | DELIVERED | LPW | DELIVERED | LPW | DELIVERED | LPW | DELIVERED | LPW |
| 80S11A | 11 | 454 | 41 | 991 | 90 | 1093 | 99 | 1095 | 100 | 1019 | 93 | 1145 | 104 |
| 80S17A | 17 | 619 | 36 | 1435 | 84 | 1701 | 100 | 1655 | 97 | 1513 | 89 | 1640 | 96 |
| 90S11A | 11 | 391 | 35 | 851 | 86 | 939 | 95 | 941 | 96 | 875 | 89 | 984 | 100 |
| 90S17A | 17 | 532 | 31 | 1233 | 76 | 1461 | 90 | 1422 | 87 | 1300 | 80 | 1409 | 86 |
| 97S11A | 11 | 337 | 30 | 747 | 68 | 824 | 75 | 826 | 75 | 768 | 70 | 864 | 79 |
| 97S17A | 17 | 460 | 27 | 1083 | 64 | 1283 | 75 | 1249 | 73 | 1141 | 67 | 1237 | 73 |
| 90L11A (2700K-1800K) | 11 | - | - | 830 | 75 | 945 | 86 | 920 | 84 | 851 | 77 | 918 | 83 |
| 90L11A (3000K-1800K) | 11 | - | - | 872 | 79 | 993 | 90 | 967 | 88 | 895 | 81 | 964 | 88 |
| 90L17A (2700K-1800K) | 17 | - | - | 1107 | 65 | 1261 | 74 | 1227 | 72 | 1135 | 67 | 1223 | 72 |
| 90L17A (3000K-1800K) | 17 | - | - | 1164 | 68 | 1326 | 78 | 1291 | 76 | 1194 | 70 | 1287 | 76 |
| 90T17A (4000K-1800K) | 17 | - | - | 798 | 47 | 917 | 54 | 896 | 53 | 811 | 48 | 910 | 54 |
| 90T17A (5000K-2700K) | 17 | - | - | 791 | 47 | 909 | 53 | 888 | 52 | 803 | 47 | 902 | 53 |

Part L

75+ LPW configurations comply with residential Part L
95+ LPW configurations comply with commercial Part L

UNIFIED GLARE RATING

| 10° OPTIC FIELD REDUCER | 15° OPTIC SOFT FOCUS LENS | 20° OPTIC SOFT FOCUS LENS | 25° OPTIC SOFT FOCUS LENS | 40° OPTIC SOFT FOCUS LENS | 60° OPTIC SOFT FOCUS LENS |
|----------------------------|------------------------------|------------------------------|------------------------------|------------------------------|------------------------------|
| >19 | <16 | <10 | <10 | <10 | <16 |

MEDIA LIGHT LOSS MULTIPLIER

| MEDIA | LIGHT LOSS FACTOR |
|------------|-------------------|
| No Lens | 1.05 |
| CGL | 0.97 |
| SFL | 1.00 |
| FGL | 0.85 |
| FSFL | 0.82 |
| FLSL | 0.78 |
| HCL | 0.75 |
| SFL W/ HCL | 0.68 |
| FGL W/ HCL | 0.47 |

OUTPUT MULTIPLIER

| CCT | CCT SCALE |
|-------|-----------|
| 2400K | 0.85 |
| 2700K | 0.97 |
| 3000K | 1.000 |
| 3500K | 1.03 |
| 4000K | 1.08 |

TUNABLE WHITE MULTIPLIER

| CCT | 5000K-2700K | 4000K-1800K |
|-------|-------------|-------------|
| 5000K | 1.16 | - |
| 4000K | 1.08 | 1.14 |
| 3500K | 1.04 | 1.07 |
| 3000K | 1.00 | 1.00 |
| 2700K | 0.96 | 0.92 |
| 2400K | - | 0.84 |
| 1800K | - | 0.69 |

MONOPOINT INTERNATIONAL CM1 SURFACE MOUNT

WARM DIM PERFORMANCE - SOFT FOCUS LENS - 25° OPTIC

| INCANDESCENT PROFILE | | | | | | | |
|---------------------------|-----------------|---------------|---------------|---------------|---------------|---------------|--------------|
| 90L11AWL 2700K - 1800K | Full on 100% | Dimmed to 80% | Dimmed to 70% | Dimmed to 50% | Dimmed to 20% | Dimmed to 10% | Dimmed to 2% |
| CCT (K) | 2700 | 2700 | 2700 | 2600 | 2200 | 1900 | 1800 |
| Light Output (Lm) | 920 | 736 | 644 | 460 | 184 | 92 | 18 |
| Power (W) | 11 | 8.8 | 7.7 | 5.5 | 2.2 | 1.1 | 0.2 |
| Efficacy (LPW) | 84 | 84 | 84 | 84 | 84 | 84 | 84 |
| 90L17AWL 2700K - 1800K | Full on 100% | Dimmed to 80% | Dimmed to 70% | Dimmed to 50% | Dimmed to 20% | Dimmed to 10% | Dimmed to 2% |
| CCT (K) | 2700K | 2700K | 2700K | 2700K | 2500K | 1950K | 1800K |
| Light Output (Lm) | 1227 | 982 | 859 | 614 | 245 | 123 | 25 |
| Power (W) | 22 | 17.6 | 15.4 | 11 | 4.4 | 2.2 | 0.4 |
| Efficacy (LPW) | 72 | 72 | 72 | 72 | 72 | 72 | 72 |

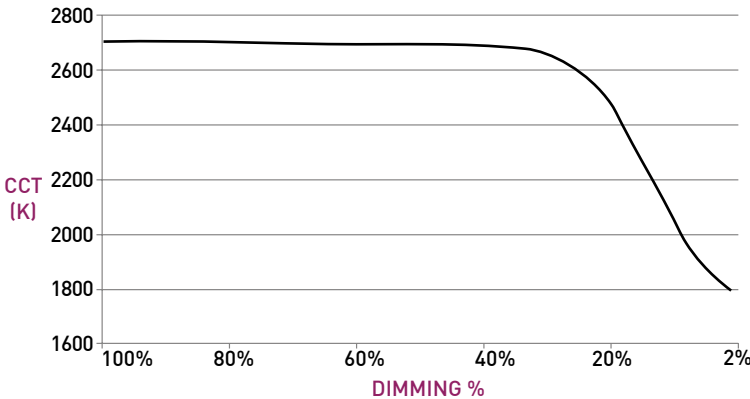

NOTE: LIN-TO-LIN 0-10V PAIRING NOT COMPATIBLE WITH WARM DIM.

| HALOGEN PROFILE | | | | | | | |
|---------------------------|-----------------|---------------|---------------|---------------|---------------|---------------|--------------|
| 90L11AWD 3000K - 1800K | Full on 100% | Dimmed to 80% | Dimmed to 70% | Dimmed to 50% | Dimmed to 20% | Dimmed to 10% | Dimmed to 2% |
| CCT (K) | 3000 | 3000 | 3000 | 3000 | 2500 | 1900 | 1800 |
| Light Output (Lm) | 967 | 774 | 677 | 484 | 193 | 97 | 19 |
| Power (W) | 11 | 8.8 | 7.7 | 5.5 | 2.2 | 1.1 | 0.2 |
| Efficacy (LPW) | 88 | 88 | 88 | 88 | 88 | 88 | 88 |
| 90L17AWD 3000K - 1800K | Full on 100% | Dimmed to 80% | Dimmed to 70% | Dimmed to 50% | Dimmed to 20% | Dimmed to 10% | Dimmed to 2% |
| CCT (K) | 3000K | 3000K | 3000K | 3000K | 3000K | 2150K | 1800K |
| Light Output (Lm) | 1291 | 1033 | 904 | 646 | 258 | 129 | 26 |
| Power (W) | 22 | 17.6 | 15.4 | 11 | 4.4 | 2.2 | 0.4 |
| Efficacy (LPW) | 76 | 76 | 76 | 76 | 76 | 76 | 76 |

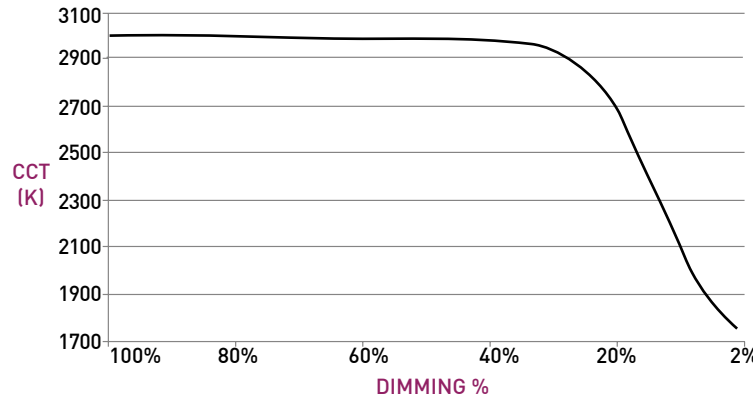

MONOPOINT INTERNATIONAL CM1 SURFACE MOUNT

MONOPOINT

A EXPORT MOUNTING PLATE

Export mounting plate (concealed) to be installed above ceiling substrate. Features minimalist 66mm diameter canopy

B STEM

Standard length is 1.4", available in even-inch increments between 2"-12". Stem is not field cuttable. Powdercoat finishes standard, consult factory for Alumina finishes.

C BODY

Available in powdercoat and Alumina finishes. Power supply integrated into fixture body.

D OPTICS

Robust light engine with optimized optic pairing integrates Reflection, Refraction, and TIR offering 10°, 15°, 20°, 25°, 40° & 60° beams.

E 10° FIELD REDUCER

Soft Focus Lens, Honeycomb Louver, and Field Reducer provided with 10° optic. Reduces field angle by 30%.

F MEDIA

Soft Focus Lens standard. Wet location media sealed in place.

G BAFFLE

Accepts 2 media devices. Baffle minimizes aperture glare and conceals view into fixture. Powdercoat finishes standard, consult factory for Alumina finishes.

H CANOPY

Adjustable Dry/Damp fixture features 0.175" and Fixed Wet fixture features 0.3" tall canopy.

I ADJUSTABLE FIXTURE

Features 90° tilt and 365° rotation. Only available for Dry / Damp locations.

J FIXED FIXTURE

Available with pre-set tilts of 0°, 15°, 30°, or 45°, and features 365° rotation. IP65 Wet rated, may be used in Dry / Damp locations.

IMPORTANT: FIXED FIXTURE TILT CANNOT BE ADJUSTED OR CHANGED IN THE FIELD, FIXTURES MUST BE RETURNED TO FACTORY FOR TILT CHANGES AT ADDITIONAL COST.

REMOTE POWER SUPPLY

K Remote power supply provides additional driver options. See page 5 for maximum allowable wiring distance. Must be installed in an accessible location.

DIMENSIONS / DRAWINGS

A EXPORT MOUNTING PLATE

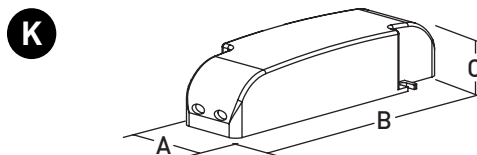
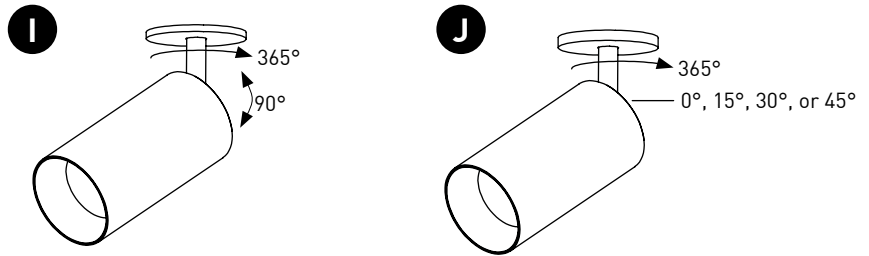
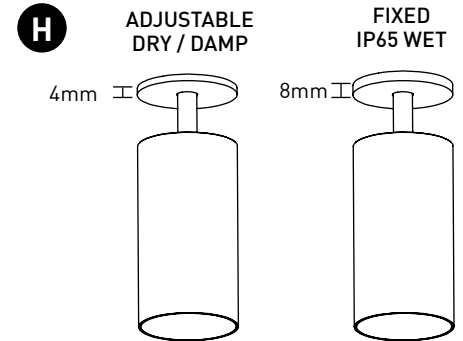
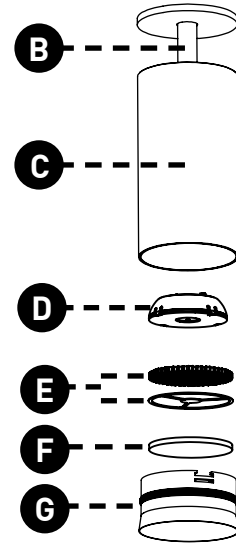
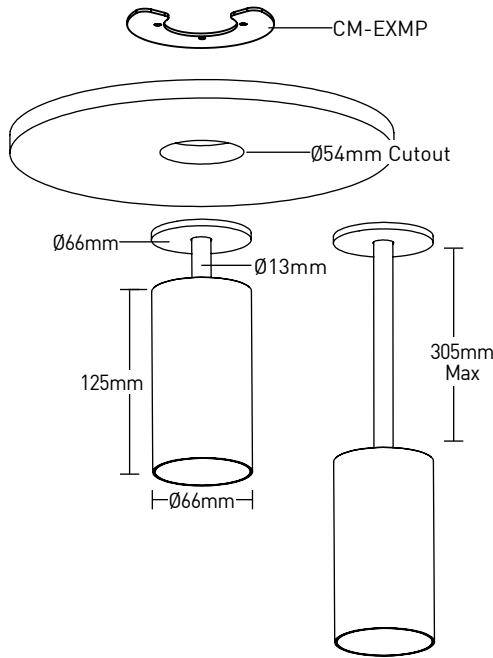

| POWER SUPPLY DIMENSIONS | | | |
|-------------------------|------|-------|------|
| Model | A | B | C |
| IG | 41mm | 210mm | 34mm |
| IN | | | |
| ID | 76mm | 130mm | 30mm |
| DD | | | |

MONOPOINT INTERNATIONAL CM1 SURFACE MOUNT

TECHNICAL

CONSTRUCTION

Monopoint: Machined aluminum body; painted finishes are granulated powder coat; Alumina finishes are anodized aluminum.

STATIC WHITE LED

2-step MacAdam ellipse LED module available in 80+, 90+ and 97+ CRI configurations in color temperatures of 2700K, 3000K, 3500K and 4000K.
3-step MacAdam ellipse LED module available in 90+ CRI configurations in color temperature of 2400K. Average rated lamp life of 50,000 hours.

WARM DIM LED

3-step MacAdam ellipse warm dim LED module available in 90+ CRI configuration. 3000K or 2700K at full brightness, warming to 1800K at full dim. Average rated lamp life of 50,000 hours.

TUNABLE WHITE LED

3-step MacAdam ellipse tunable white LED module available in 90+ CRI configuration. Features tuning ranges of 1800K to 4000K and 2700K to 5000K. Average rated lamp life of 50,000 hours.

POWER SUPPLY PERFORMANCE AND DIMMING INFORMATION

| | PHASE | | 0-10V | | DALI | |
|--------------|--------|--------|--------|--------|--------|--|
| Power Supply | IE | IG | IN | ID | DD | |
| Minimum °C | -20 °C | -20 °C | -20 °C | -20 °C | -20 °C | |
| Maximum °C | 40 °C | 40 °C | 40 °C | 40 °C | 40 °C | |
| Dimming % | 2.0% | 0.1% | 0.1% | 0.1% | 0.1% | |

Note: For IG and IN drivers consult chart on page 7 to confirm appropriate dimming curve for compatibility with selected control.

MAXIMUM ALLOWABLE REMOTE DRIVER WIRING DISTANCES

| DRIVER | WIRE AWG | | | | |
|----------------|----------|----|------|-----|-----|
| | 12 | 14 | 16 | 18 | 20 |
| IG, IN, ID, DD | - | - | 118' | 72' | 46' |

LISTING

Monopoints and drivers CE Listed for Dry / Damp and IP65 Wet locations. Integral drivers ENEC and CB Listed. NOM Certified.

DECLARE

LBC Red List Approved.

PART L

Part L compliant for all 75+ LPW residential and 95+ LPW commercial configurations.

LIMITED WARRANTY

Manufacturer's Limited Warranty guarantees product(s) listed to be free from defects in material and workmanship under normal use and service for 1-year. LED and power supplies are warranted to operate with 70% of original flux and remain within a range of 3 duv for a period of 5-years. Warranty period begins from the date of shipment by Seller. [Consult website for full warranty terms and conditions.](#)

CHANGE LOG

1. 04/27/2023: ADDED AU AND BB FINISHES OPTIONS FOR BODY AND STEM.
2. 08/07/2023: ADDED NEW LED AND OPTIC OFFERINGS. REMOVED 2400K OFFERING.
3. 01/17/2024: ADDED IP65 WET RATED FIXED FIXTURE, 2400K, AND INTEGRAL WARM DIM OFFERINGS.
4. 02/13/2024: ADDED TUNABLE WHITE OFFERING.
5. 2/15/2024: PART L COMPLIANCE ADDED.
6. 03/18/2024: UPDATED 10 DEGREE NARROW BEAM TO UTILIZE FILED REDUCER.
7. 09/19/2024: UPDATED WITH NEW BAFFLE DESIGN.
8. 05/07/2025: UPDATED WARM DIM OFFERING.



MONOPOINT INTERNATIONAL CM1 SURFACE MOUNT

DIMMING COMPATABILITY

eldoLED DRIVER COMPATIBILITY

| Power supply IG Manufacturer | Family/Model # |
|--|--------------------------------|
| Busch-Jaeger | 2112U-101 |
| Jung | 240-10 |
| Leviton Lighting Controls | IP710-DLX |
| Lightolier Controls | ZP600FAM120 |
| Merten | 5729 |
| Pass & Seymour | CD4FB-W |
| The Watt Stopper | DCLV1 |
| Synergy | ISD BC |
| Crestron® | GLX-DIMFLV8 |
| Crestron® | GLXP-DIMFLV8 |
| Crestron® | GLPAC-DIMFLV4-* |
| Crestron® | GLPAC-DIMFLV8-* |
| Crestron® | GLPP-DIMFLVEX-PM |
| Crestron® | GLPP-1DIMFLV2EX-PM |
| Crestron® | GLPP-1DIMFLV3EX-PM |
| Crestron® | DIN-A08 |
| Crestron® | DIN-4DIMFLV4 |
| Crestron® | CLS-EXP-DIMFLV |
| Crestron® | CLCI-1DIMFLV2EX |
| Power supply IN Manufacturer | Family/Model # |
| Lutron Electronics | Nova T® - NTFTV |
| Lutron Electronics | Diva® - DDTV |
| Lutron Electronics | Nova® - NFTV |
| Lutron Electronics | GrafixEye® GRX-TVI w GRX3503 |
| Lutron Electronics | Energy Savr Node™ - QSN-4T16-S |
| Lutron Electronics | TVM2 Module |
| Sensor Switch | nIO EZ |
| ABB | SD/S 2.16.1 |